



168 Hillrise Park, Clydach, Swansea, SA6 5ED

Open To Offers £80,000

Offered for sale with No Chain a two bedroom end of terrace town house. Having easy access to the M4, Clydach, Morriston shops, Hospital and schools.

The accommodation comprises to the ground floor; entrance hall with a staircase leading to the lounge/dining room and integral garage. The the first floor is the lounge/dining room and kitchen. On the second floor you will find two double bedrooms and a bathroom.

The property benefits from gas central heating, double glazing, driveway and garage. The property is in need of some modernisation.

The Accommodation Comprises

Ground Floor

Hall

Entered via door to front, radiator, staircase to first floor.

Integral Garage

With up and over door.

First Floor

Kitchen 8'1" x 11'10" (2.46m x 3.60m)



Fitted with a range of wall and base units with worktop space over, 1+1/2 bowl sink unit, tiled splashbacks, plumbing for washing machine, space for fridge/freezer and cooker with electric points for a cooker, radiator, wall mounted boiler, double glazed window and door to rear.

Lounge/Dining Room 22'6" x 6'7" (6.85m x 2.00m)



Two double glazed windows to front, two radiators, laminate flooring, staircase leading to the first floor.

Second Floor

Landing

Access to loft, storage cupboard.

Bedroom 1 10'11" x 11'10" (3.33m x 3.60m)



Double glazed window to rear, laminate flooring, storage cupboard, radiator.

Bedroom 2 9'7" x 11'10" (2.92m x 3.60m)



Double glazed window to front, radiator.

Bathroom



Three piece suite comprising bath with shower over, wash hand basin and WC. Frosted double glazed window to side, radiator.

External



Agents Note

TENURE - Freehold

Council Tax Band - A - Annual Price - £1,188 (min)

Floor Plan

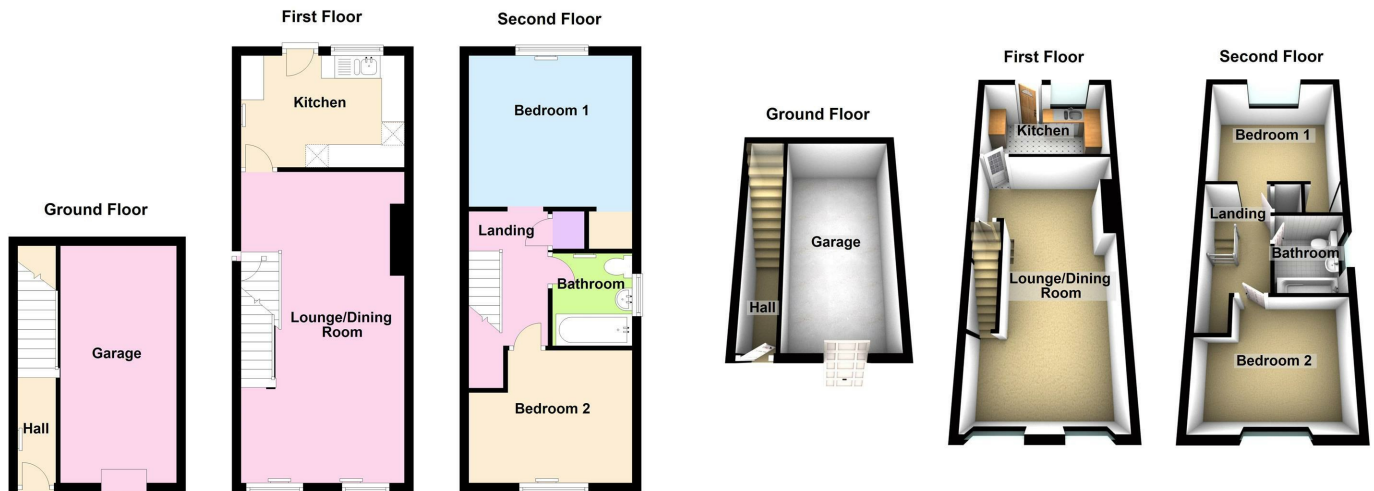

Area Map

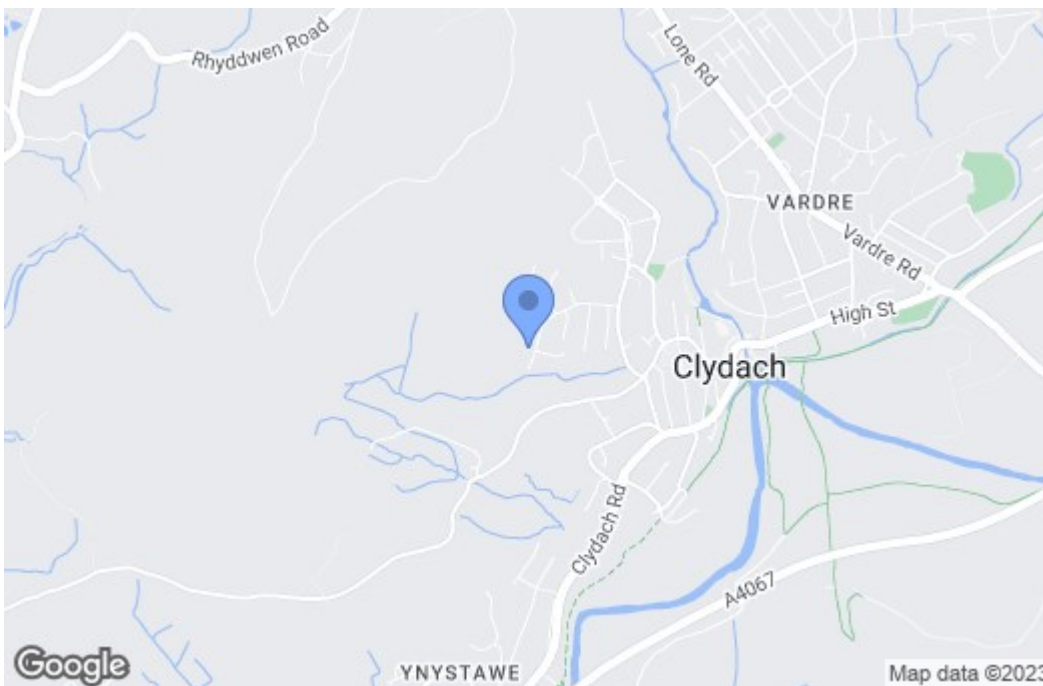

Energy Efficiency Graph

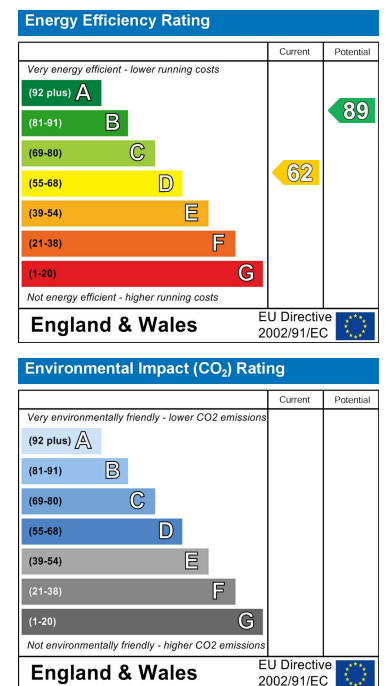

These particulars, whilst believed to be accurate are set out as a general outline only for guidance and do not constitute any part of an offer or contract. Intending purchasers should not rely on them as statements of representation of fact, but must satisfy themselves by inspection or otherwise as to their accuracy. No person in this firm's employment has the authority to make or give any representation or warranty in respect of the property.